

Courses Down Monongahela

- East... 28
- N 82 E 47
- N 75 E 38
- N 66 E 30
- N 56 E 16
- N 50 E 40
- N 45 E 41
- N 40 E 56
- N 31 E 37
- N 16 E 37
- N 17 E 84
- Total 448 ps

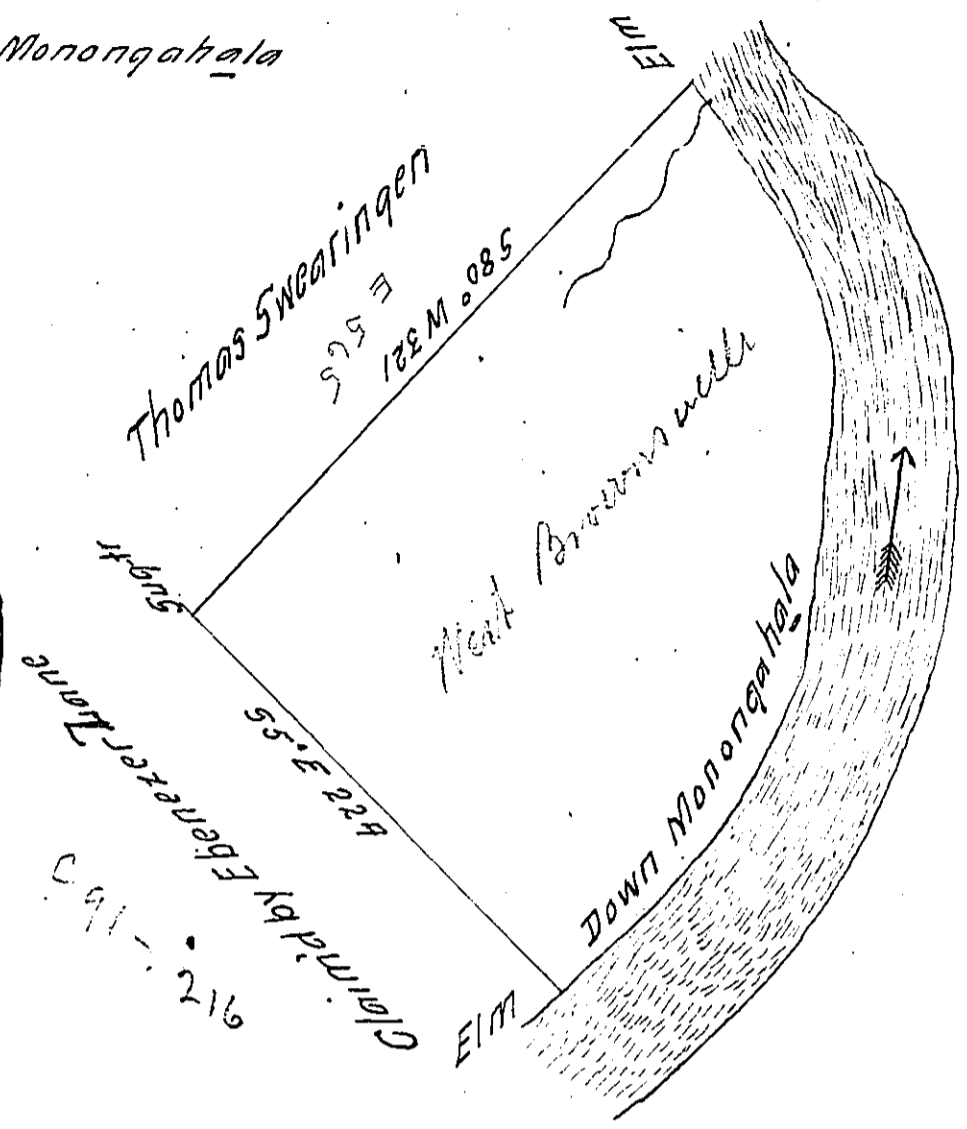

In pursuance of an order N<sup>o</sup> 2847 dated 5<sup>th</sup> April 1769 the above tract Draught of a tract of Land call'd Indian Hill containing 339 Acres of the usual allowance of 600 for Roads & situate on the West side Monongahela Survey'd 7<sup>th</sup> October 1739 for William Peters (alias) Indian Peter

To *John Lukens Esq<sup>r</sup>* by *James Hendricks D.S.*  
 obliterated

IN TESTIMONY that the above is a copy of the original remaining on file in the Department of Internal Affairs of Pennsylvania, made conformably to an Act of Assembly approved the 16th day of February, 1833, I have hereunto set my Hand and caused the Seal of said Department to be affixed at Harrisburg, this *Sixth* day of *May* 1912

*Henry Foucault*  
 Secretary of Internal Affairs.